

## LED 24

2-pole plug-in system LED 24 connecting cable 2,5m



### Description:

connecting cable with LED 24 plug and LED 24 coupling

**Connection:** LED-Trafo DC 24 V

**Symbols:** CE, IP20, SK III

**EAN-No.:** 4051268271608

**Weight:** 0,022 kg

### Special features:

- for constant voltage (reverse polarity protected)
- output: max. 48 W
- plug only 7,9 mm in diameter (fits through 8 mm drill hole)
- plug for connecting cable only 8,5 mm in diameter (fits through 9 mm drill hole)
- cable 2 x 0,21 mm<sup>2</sup>

### Drilling hole



8mm

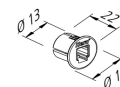
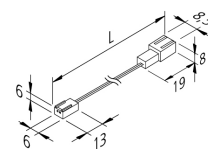
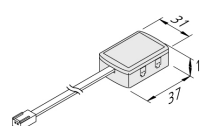

**Order number:**  
21530062501

article in stock

## available versions

Choose from the options below. The currently selected one is highlighted in color.

article number	description	drilling diameter
21530060102	LED 24 connecting cable 0,1m	8mm
21530060501	LED 24 connecting cable 0,5m	8mm
21530061001	LED 24 connecting cable 1,0m	8mm
<b>21530062501</b>	<b>LED 24 connecting cable 2,5m</b>	<b>8mm</b>
21530000101	LED 24 mounting socket for wood	13mm
21508060706	LED 24 4-way distributor	-

