



## SlimLite® CS LED HE+ Meat R

180° rotating 230V aluminium linear luminaire SlimLite CS LED HE+ 1195mm 10,3W Meat R



### Description:

LED linear luminaire for 230V, rotating 180°, rigid connectors for minimum spacing between luminaires, vertical plug-in system allows later removal from the strip light, solid aluminium casing, easy mounting through enclosed clips, many accessories like horizontal or vertical connection cables, distributor and flush-type sockets with with small (7,5mm diameter) high-voltage plug-in system ready for connection with Tyco AMP, corner mounting clips 45° or angle mounting clips 90°, colour appearance Meat R for butcher counters

**Connection:** 220 - 240V / 50 - 60Hz  
**Life:** L70/B10 >= 60.000 h  
**Light colour:** Meat (colour appearance)  
**Energy efficiency:** LED 80 lm/W; luminaire: 550 lm/m (55 lm/W)  
**Energy efficiency class:** E  
**Colour rendering:** Ra/CRI >= 85  
**Symbols:** CE, MM, IP20, SK II  
**EAN-No.:** 4051268203319  
**Weight:** 0,75 kg

### Special features:

- LEDs rotating 180°
- rigid connectors for minimum spacing between luminaires
- vertical plug-in system allows later removal from the strip light
- many accessories

### SlimLite® CS LED HE+

	110°	Ø	Meat R
0,5m		610	780 lx
1,0m		1220	195 lx
1,5m		1830	87 lx
2,0m		2440	49 lx
2,5m		3050	31 lx

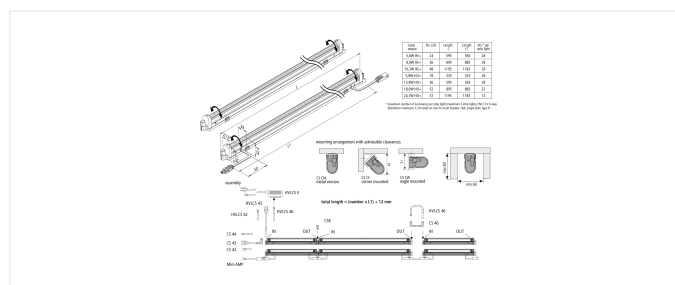

**Order number:**  
61001294305

article in stock

## available versions

Choose from the options below. The currently selected one is highlighted in color.

article number	description
61001294105	SlimLite CS LED HE+ 595mm 5,8W Meat R
61001294205	SlimLite CS LED HE+ 895mm 8,9W Meat R
61001294305	SlimLite CS LED HE+ 1195mm 10,3W Meat R

Lamp output	No. LED	Length L	Length L <sub>f</sub>	No.° per strip light
5,8W HE+	24	595	583	28
8,9W HE+	36	895	883	28
10,3W HE+	48	1195	1183	28
5,8W HO+	18	335	323	28
13,8W HO+	36	595	583	28
18,0W HO+	52	895	883	22
24,7W HO+	72	1195	1183	13

\* maximum number of luminaires per strip light (maximum 3 strip lights, HVLCS V 6-way distributor maximum 2,5A total) on one N-circuit breaker 16A, single pole, type B

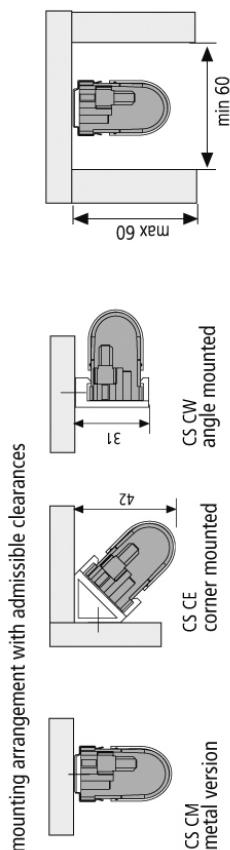
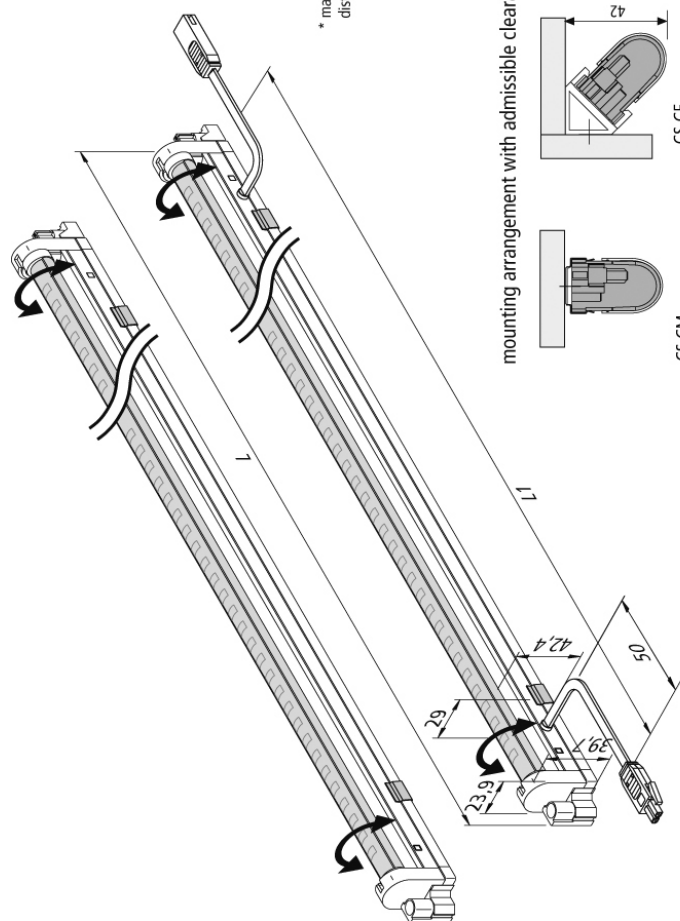

**total length = (number x L1) + 12 mm**

