

## Track 24V

24V DC adjustable Track feeder element anodized aluminium



### Description:

LED power rail feeder element, incl. feeder clamp

**Connection:** LED-Trafo DC 24 V

**Symbols:** CE, MM, UL, IP20, SK III

**EAN-No.:** 4051268130981

**Weight:** 0,007 kg

### Special features:

- adapter with double LED 24-connector for optional power supply of two shelves

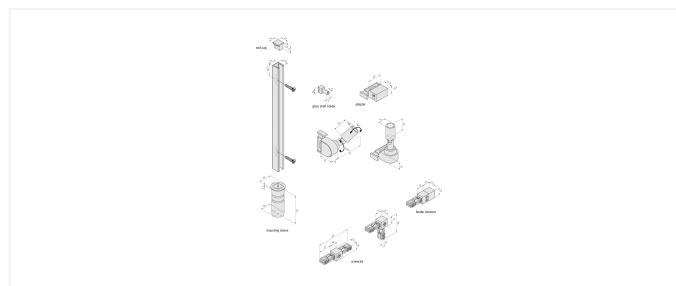

**Order number:**  
21800020127

limited availability

## available versions

Choose from the options below. The currently selected one is highlighted in color.

article number	description	colour of housing	metal housing	drilling diameter
21800080103	Track adapter black	black	Yes	-
21800080107	Track adapter anodized aluminium	anodized aluminium	Yes	-
21800010103	LED Track 300mm black	black	Yes	-
21800010107	LED Track 300mm anodized aluminium	anodized aluminium	Yes	-
21800010203	LED Track 600mm black	black	Yes	-
21800010207	LED Track 600mm anodized aluminium	anodized aluminium	Yes	-
21800010303	LED Track 1000mm black	black	Yes	-
21800010307	LED Track 1000mm anodized aluminium	anodized aluminium	Yes	-
21800020123	Track feeder element black	black	No	-
<b>21800020127</b>	<b>Track feeder element anodized aluminium</b>	<b>anodized aluminium</b>	<b>No</b>	<b>-</b>
21800030103	LED Track Connector black	black	No	-
21800030107	LED Track Connector anodized aluminium	anodized aluminium	No	-
21800040103	LED Track Corner Connector black	black	No	-
21800040107	LED Track Corner Connector anodized aluminium	anodized aluminium	No	-
21800050107	LED Track End Cap anodized aluminium	anodized aluminium	No	-
21800050103	LED Track End Cap black	black	No	-
21800070117	LED Track Mounting Sleeve anodized aluminium	anodized aluminium	No	20mm
21800070113	LED Track Mounting Sleeve black	black	No	20mm
21800060100	LED Track Glass Shelf Holder	-	No	-
21800020103	LED Track Feeder Element black	black	No	-
21800020107	LED Track Feeder Element anodized aluminium	anodized aluminium	No	-

